

**eufy** SECURITY

Anker Innovations Limited. All rights reserved. Eufy and the Eufy logo are trademarks of Anker Innovations Limited, registered in the United States and other countries. All other trademarks are the property of their respective owners.

51005001157 V01

# User Manual

eufy Security SpaceView  
Baby Monitor



## Table of Content

What's in the Box	01
Feature Introduction	02
Setting Up the Camera and Monitor	03
Monitor Installation	03
Replacing the Camera lens	06
Safety	07
Customer service	10

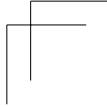
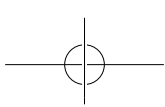
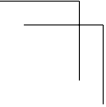

## What's in the Box



Baby Monitor  
(T8300-C)



Baby Camera  
(T8300-M)



Camera Stand



Monitor Micro-USB  
Power Cable (1.5 m)



Camera Micro-USB  
Power Cable (3 m)



Camera Adapter  
(5V 2A)



Monitor Adapter  
(5V 2A)



Screw Kit



Wide-Angle Lens



User manual



Power adapter varies by region.

01

## Feature Introduction

### Monitor Features:

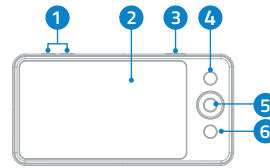

- 1 Volume controls
- 2 Screen
- 3 Power button
- 4 Menu button
- 5 Navigation buttons
- 6 Return to previous level of menu / Talk button
- 7 Monitor Antenna

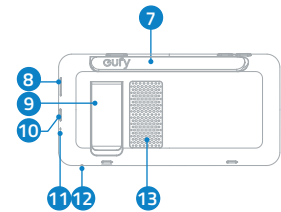

- 8 microSD card slot
- 9 Support stand
- 10 Micro USB charging port
- 11 LED indicator
- 12 Microphone
- 13 Speaker



Press and hold the Talk button to speak to the camera. When Menu is opened, press Talk button once to return to previous level of menu. Press Power button to switch on / off the monitor screen. Press and hold the Power button for 2 seconds to switch on / off the monitor.

02

### Camera Features:

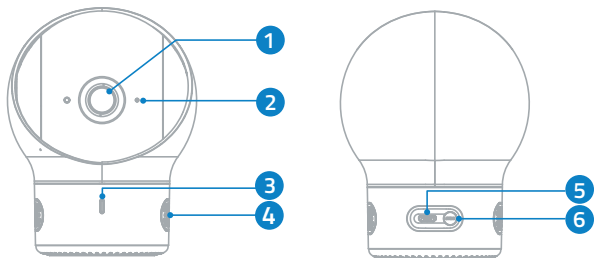

- |                              |                  |
|------------------------------|------------------|
| 1 Standard camera lens       | 4 Speaker        |
| 2 Microphone                 | 5 Micro USB port |
| 3 Power LED Status indicator | 6 Pairing button |

## Setting Up the Camera and Monitor

### Monitor Installation

Fully charge the monitor before use. To charge:

Connect the baby monitor to the monitor adapter with the Micro USB cable, and then connect the adapter to a power outlet. Connect the other end of the baby monitor's Micro USB power cable to the Micro USB port in the monitor to

03

charge it. Press and hold the power button for 2 seconds to turn the baby monitor on.

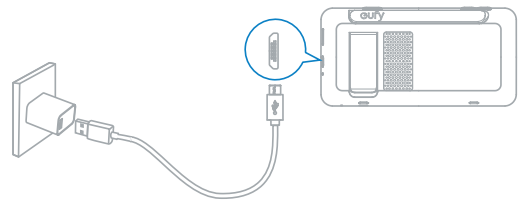

### Camera Installation

Connect the baby camera's Micro USB power cable to the camera adapter (5V 2A), and then connect the adapter to a power outlet. Finally, connect the other end of the baby camera's micro USB power cable to the micro USB port in the camera.

### Camera Placement (on the Wall Mount)

1. Use the monitor to test the viewing angle from your desired mounting spot.
2. Mark the screw holes with a pencil.
3. Drill 1/5" holes into the wall and then insert the anchors into the holes.
4. Insert the screws through the mounting holes of the base and screw into the anchors.
5. Place the camera on the base.

04

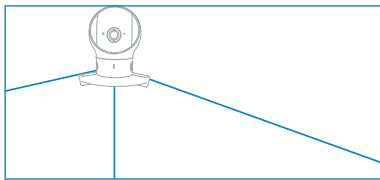

### On-screen Menu Icons

Icon	Icon Description
	Wireless signal strength
	Night Vision Mode is enabled
	Shows the camera that is currently presenting on the baby monitor screen
	Cycle Cameras enabled
	Temperature Alert enabled / Sound Alert enabled
27°C	Ambient temperature of the room the camera is in
	Sound level of the room the camera is in
17:30	Current time
	Current battery level of the baby monitor

05

### Replacing the Camera lens

Lens type	Usage	Demonstration
Standard camera lens (default lens)	This lens is recommended for general viewing; infants are clearly seen within a 2~3m range. The lens angle of view for standard camera lens is 62°.	
Wide-angle lens	This lens provides a wide-angle view of the room. The lens angle of view for wide-angle lens is 110°.	

The standard camera lens is not removable. When you want to use the wide-angle lens, simply place it over the standard camera lens and fasten.

06

## Safety

### Warning

Strangulation Hazard: Children have STRANGLED in cords. Keep this cord out of the reach of children (more than 1m (3ft) away). Never use extension cords with AC Adapters. Only use the AC Adapters provided.

**CE** This device in compliance with the essential requirements and other relevant provisions of Directive 2014/53/EU. All essential radio test suites have been carried out.

This product can be used across EU member states.

The product shall only be connected to a USB Interface of version 2.0 or higher.

1. The adapter shall be installed near the equipment and shall be easily accessible.
2. Do not use the product in the environment at too high or too low temperature, never expose the mobile phone under strong sunshine or too wet environment.

The suitable temperature for the product and accessories is  $-20^{\circ}\text{C}$ - $60^{\circ}\text{C}$ .

When charging, please place the product in an environment that has a normal room temperature and good ventilation. It is recommended to charge the product in an environment

with a temperature that ranges from  $-10^{\circ}\text{C}$ - $45^{\circ}\text{C}$ . Please ensure to use only the charger offered by the manufacturer. Using unauthorized charger may cause danger and violate the authorization of the phone and the guarantee article.

3. CAUTION RISK OF EXPLOSION IF BATTERY IS REPLACED BY AN INCORRECT TYPE. DISPOSE OF USED BATTERIES ACCORDING TO THE INSTRUCTIONS

4. RF exposure information: The Maximum Permissible Exposure (MPE) level has been calculated based on a distance of  $d=20$  cm between the device and the human body. To maintain compliance with RF exposure requirement, use product that maintain a 20cm distance between the device and human body.

6. Operating Frequency Range: 2410-2477MHz

7. The charger output voltage/current is 5Vdc/2A. The plug considered as disconnect device of adapter.

8. If you use a third-party charger, the recommended output voltage/current of the adaptor is 5Vdc/2A, and the adapter shall be CE approval type.

9. The following importer is the responsible party (contact for EU matters only)

Importer: Anker Technology (UK) Ltd

Importer Address: Suite B, Fairgate House, 205 Kings Road, Tyseley, Birmingham, United Kingdom B11 2AA



This product is designed and manufactured with high quality materials and components, which can be recycled and reused.



This symbol means the product must not be discarded as household waste, and should be delivered to an appropriate collection facility for recycling. Proper disposal and recycling helps protect natural resources, human health and the environment. For more information on disposal and recycling of this product, contact your local municipality, disposal service, or the shop where you bought this product.

### FCC Statement

This device complies with Part 15 of the FCC Rules. Operation is subject to the following two conditions: (1) this device may not cause harmful interference, and (2) this device must accept any interference received, including interference that may cause undesired operation.

**Warning:** Changes or modifications not expressly approved by the party responsible for compliance could void the user's authority to operate the equipment.

**Note:** This equipment has been tested and found to comply with the limits for a Class B digital device, pursuant to Part 15 of the FCC Rules. These limits are designed to provide reasonable protection against harmful interference in a residential installation.

This equipment generates uses and can radiate radio frequency energy and, if not installed and used in accordance with the instructions, may cause harmful interference to radio communications. However, there is no guarantee that interference will not occur in a particular installation. If this equipment does cause harmful interference to radio or television reception, which can be determined by turning the equipment off and on, the user is encouraged to try to correct the interference by one or more of the following measures: (1) Reorient or relocate the receiving antenna. (2) Increase the separation between the equipment and receiver. (3) Connect the equipment into an outlet on a circuit different from that to which the receiver is connected. (4) Consult the dealer or an experienced radio/TV technician for help.

The following importer is the responsible party (contact for FCC matters only)

Company Name: POWER MOBILE LIFE, LLC

Address: 400 108th Ave NE Ste 400, Bellevue, WA 98004-5541

Telephone:(206)383-8247

## Customer service

- **Warranty**

12-month limited warranty

- **Call Us**

United States +1 (800) 988 7973 Mon-Fri 9AM-5PM (PT)

United Kingdom +44 (0) 1604 936 200

Mon-Fri 6AM-11AM (GMT)

Germany +49 (0) 69 9579 7960 Mon-Fri 6:00-11:00

- **Email Us**

Customer Support: [support@eufylife.com](mailto:support@eufylife.com)



@EufyOfficial



@EufyOfficial



eufyofficial

## FCC Radio Frequency Exposure Statement

The T3800-C device has been evaluated to meet general RF exposure requirements. The T3800-C can be used in fixed exposure condition. The min separation distance is 20cm.

This T3800-M was tested for typical body-worn operations with the back of the handset kept 0 mm from the body.

## RF Exposure Information(SAR)

The Extremity SAR limit of FCC for Hand held is 4.0W/kg.

Device is recommended to use in hand held only and SAR when hand held is 1.804W/kg

Worn on body will have unexpected RF exposure RISK.