

Farming Vehicle Control System
for Windows® PC

Instruction Manual

Thank you for purchasing this product.
Before use, please read the instruction manual carefully.
After reading, please keep the manual for reference.



Table of Contents

Quick Start Guide	2	How to Connect	12
Caution	3	App [HORI Device Manager]	13
Contents	4	▶ Download App	
Compatibility	4	Main Features	13
Layout and Features	5-6		
▶ Steering Wheel / Foot Pedals			
▶ Control Panel / Steering Wheel Spinner Knob			
How to Set Up	7-11		
▶ Mounting the Steering Wheel			
▶ Mounting the Control Panel			
▶ Mounting the Foot Pedals			
▶ Mounting onto a racing wheel stand			
▶ Mounting the Steering Wheel Spinner Knob			

Quick Start Guide

1

Set up the Steering Wheel, Control Panel, and Foot Pedals.

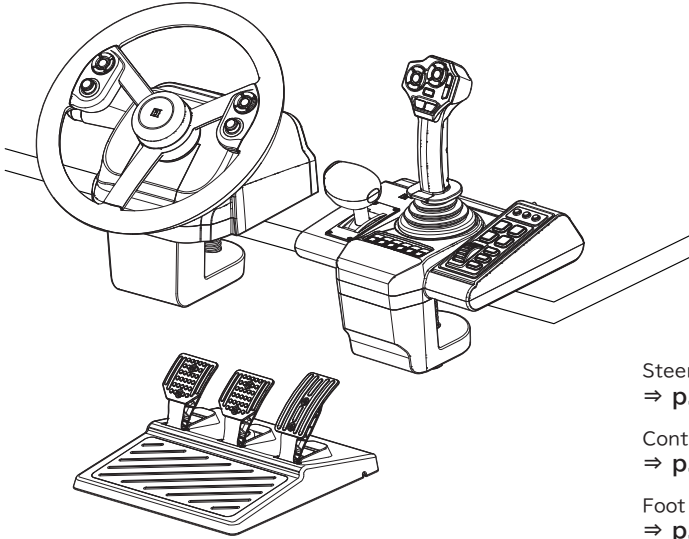

Steering Wheel Unit
⇒ p.7-8

Control Panel
⇒ p.8-9

Foot Pedals
⇒ p.9

2

Connect all of the cables accordingly.

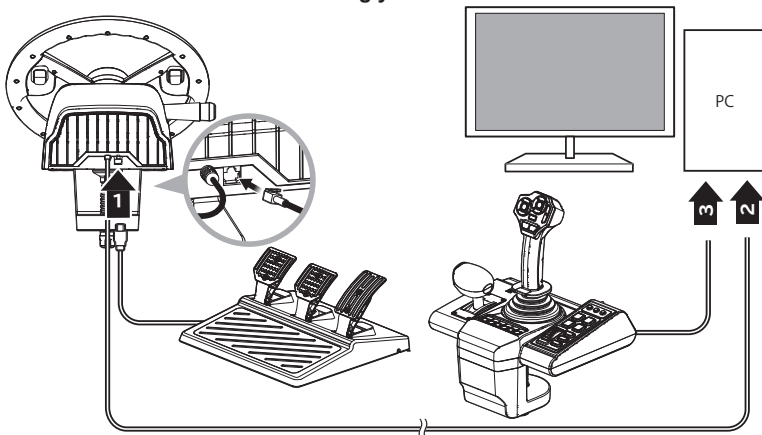

Please do not push buttons or turn the Steering Wheel, Control Panel, or Foot Pedals when connecting this product to a PC, turning on the PC, or waking the PC from sleep mode.



**Caution Parents/Guardians:
Please read the following information carefully.**

- This product contains small parts. Keep away from children under 3 years old.
- Keep this product away from small children or infants. Seek medical attention immediately if any small parts are swallowed.
- Long cord. Strangulation hazard.
- Keep the product away from dusty or humid areas.
- Do not use this product if it has been damaged or modified.
- Do not cover product with cloth. Doing so may cause overheating.
- Do not get this product wet. This may cause an electric shock or malfunction.
- Do not place this product near heat sources or leave under direct sunlight for an extended period. Overheating may cause malfunction.
- Do not use this product with a USB hub or a USB extension cord. The product may not function properly.
- Do not touch the metal parts of the USB plug.
- Do not apply strong impact or weight on the product.
- Do not pull roughly or bend the cable of the product.
- Do not disassemble, modify or attempt to repair this product.
- If product needs cleaning, use only a soft dry cloth. Do not use any chemical agents like benzene or thinner.
- The wires are not to be inserted into socket-outlets.
- The packaging must be retained since it contains important information.
- The normal function of the product may be disturbed by strong electro-magnetic interference. If so, simply reset the product to resume normal operation by following the instruction manual (How to Connect). In case the function does not resume, please relocate to an area which does not have electro-magnetic interference to use the product.
- Do not use this product for anything other than its intended purpose. We are not responsible for any accidents or damages in the event of use other than the intended purpose.
- Keep your fingers away from the foot pedals during gameplay.

Contents

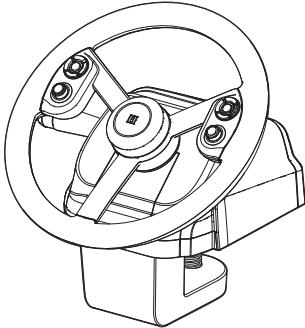

Steering Wheel ×1

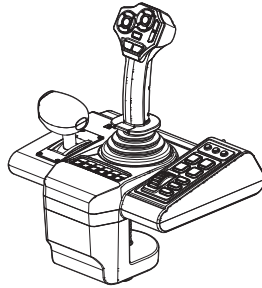

Control Panel ×1

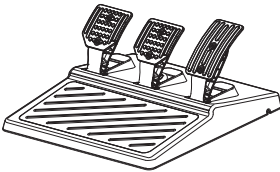

Foot Pedals ×1

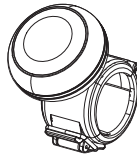

Steering Wheel Spinner Knob ×1

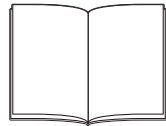

Instruction Manual ×1

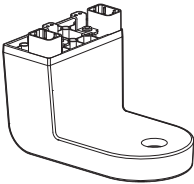

Steering Wheel Clamp ×1

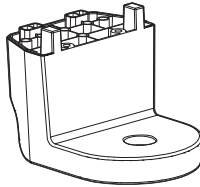

Control Panel Clamp ×1

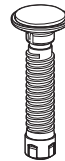

Screw ×2



Clamp Screw ×4

Compatibility

PC (DirectInput)

Supported OS	Windows®11 / 10
Input Method	DirectInput
System Requirements	USB-A port

* Functions as PC controller through DirectInput. This product does not support XInput.

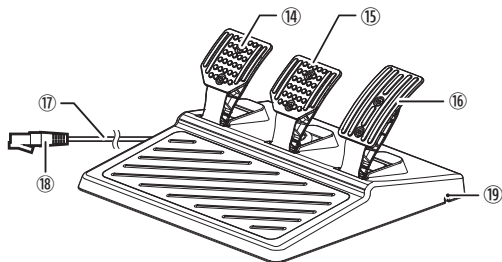
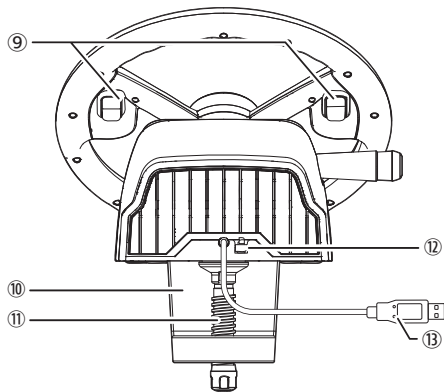
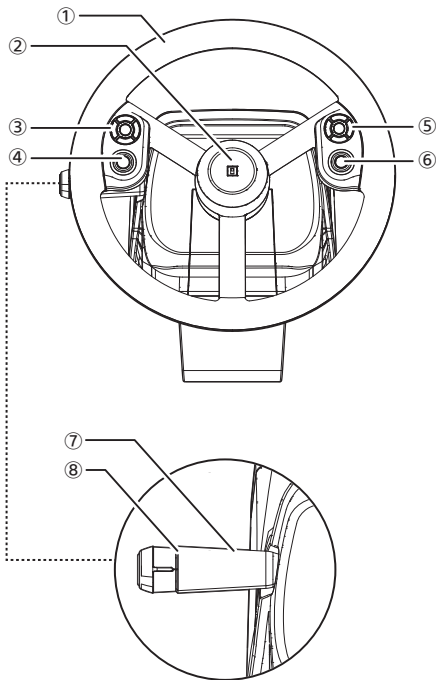

Steering Wheel

- ① ... Steering Wheel
- ② ... Horn Button (Button 7)
- ③ ... Steering Wheel Button Set (B)
D-Pad Buttons / Button 6
- ④ ... L Analog Stick (When pressed: Button 8)
- ⑤ ... Steering Wheel Button Set (A)
Buttons 1-5
- ⑥ ... R Analog Stick (When pressed: Button 9)
- ⑦ ... Turn Signal Lever
Right: Button 10 / Left: Button 11
Front: Button 12 / Back: Button 13
- ⑧ ... Turn Signal Knob
Up: Button 14 / Down: Button 15
- ⑨ ... Rear Button
Button 16 / Button 17
- ⑩ ... Clamp
- ⑪ ... Screw
- ⑫ ... Foot Pedal Connection
- ⑬ ... USB Connector

Foot Pedals

- ⑭ ... Clutch Pedal
- ⑮ ... L Pedal
- ⑯ ... R Pedal
- ⑰ ... Foot Pedal Cable*
- ⑱ ... Modular Plug
- ⑲ ... Cable Groove

* Slide the foot pedal cable through any of the three grooves on the bottom of the foot pedals.

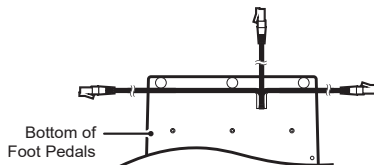

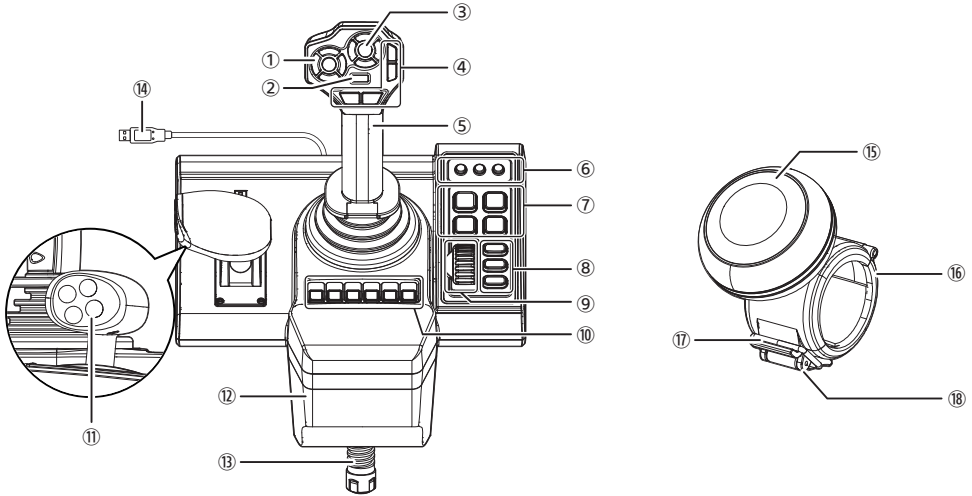

Control Panel

- ① ... Multi Function Lever Button Set (A)
Buttons 21-25
- ② ... Mode Toggle Button
- ③ ... Multi Function Lever Button Set (B)
Buttons 26-30
- ④ ... Multi Function Lever Button Set (C)
Buttons 31-34
- ⑤ ... Multi Function Lever Button Set (D)
Buttons 35-36
- ⑥ ... Light Buttons
Buttons 1-3
- ⑦ ... Panel Button Set (A)
Buttons 4-7
- ⑧ ... Panel Button Set (B)
Buttons 8-10
- ⑨ ... Scroll Wheel
Scroll up: Button 37
Scroll down: Button 38
When pressed: Button 39
- ⑩ ... Panel Button Set (C)
Buttons 11 -16
- ⑪ ... Throttle Lever Button
Buttons 17-20
- ⑫ ... Clamp
- ⑬ ... Screw
- ⑭ ... USB Connector

Steering Wheel Spinner Knob

- ⑮ ... Steering Wheel Spinner Knob
- ⑯ ... Clamp
- ⑰ ... Bracket
- ⑱ ... Locking Latch

*** About Mode Toggle Button**

When the Mode Toggle Button LED is on, it indicates that a button is held down and by combining it with another button input, it can be registered as a simultaneous button input.

Applicable buttons

Panel Unit Buttons 21-36

How to Set Up

Please read before setup

- ⚠ Support the Steering Wheel Unit / Control Panel during the mounting process until the product is fully secured.
- ⚠ Carefully detach from furniture to prevent damage to furniture or product.

■ Mounting the Steering Wheel Unit

Flat, hard surface required (i.e., table)

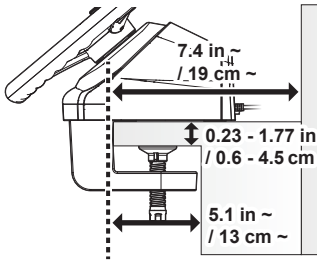

⊘ Do not attach to any unstable surface as shown in the diagram below.

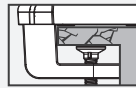
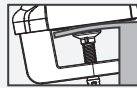
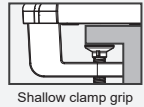
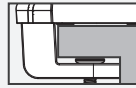
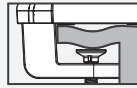

1

Pass the screw through the Steering Wheel Clamp.

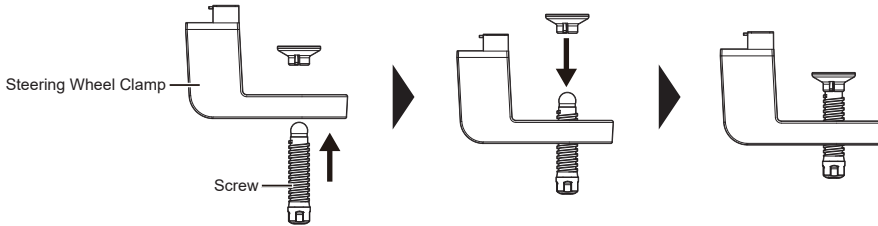

2

Insert **1** into the bottom of the steering wheel unit and use the clamp screw to secure.

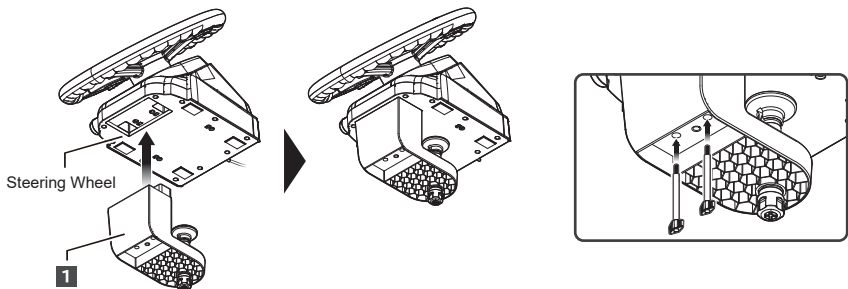

3

Place the clamp around a desk or other mounting surface and push the clamp all way in so the edge of the mounting surface is touching the inside end of the clamp.

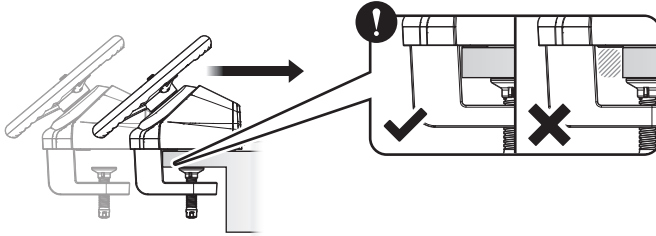
**4**

Rotate the screw clockwise while supporting the steering wheel unit and firmly secure.

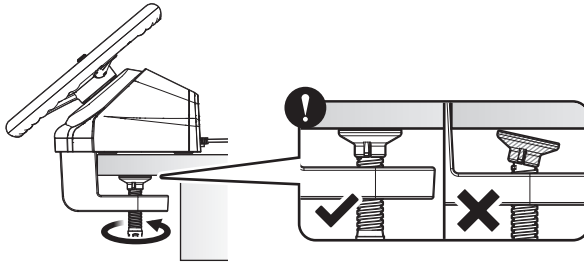

■ Mounting the Control Panel

Flat, hard surface required (i.e., table)

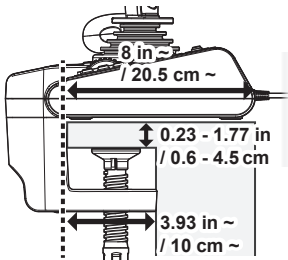

Do not attach to any unstable surface as shown in the diagram below.

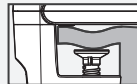

Uneven

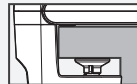

Too thick

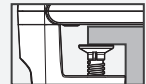

Shallow clamp grip

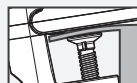

Thin or soft

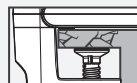

Fragile (i.e., glass)

1

Pass the screw through the Control Panel Clamp.

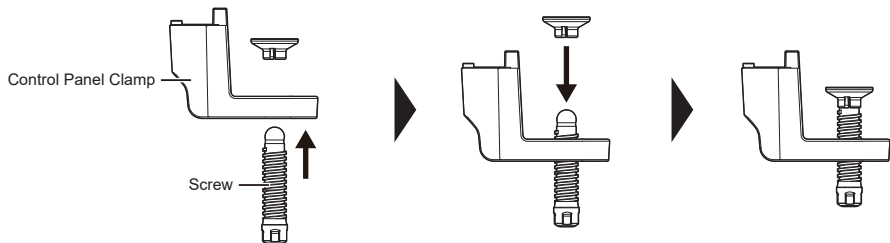

2

Insert **1** into the bottom of the Control Panel and use the clamp screw to secure.

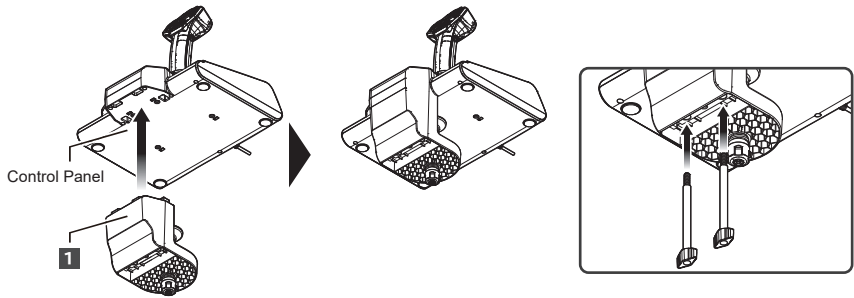

3

Place the clamp around a desk or other mounting surface and push the clamp all way in so the edge of the mounting surface is touching the inside end of the clamp.

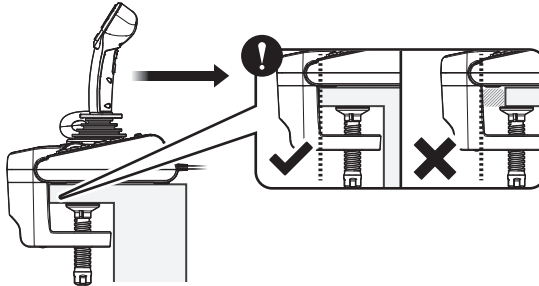

4

While holding the Control Panel in place, turn the screw to secure it firmly.

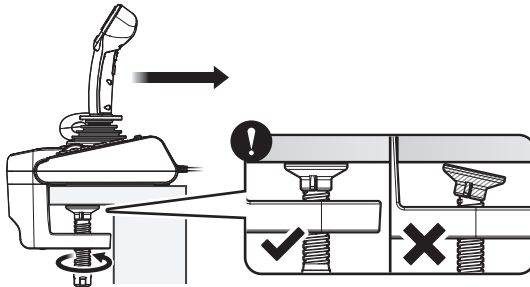

■ Mounting the Foot Pedals

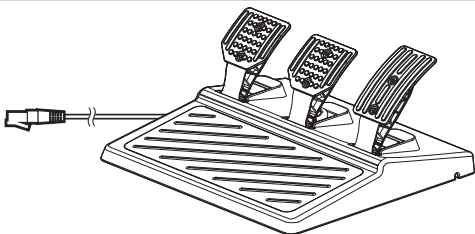

• Cable Groove

Slide the foot pedal cable through any of the three grooves on the bottom of the foot pedal.

Bottom of Foot Pedals

■ Mounting onto a racing wheel stand

Install using M6 screws as shown in the figure below.

* Installation requires a steering wheel stand and M6 screws of the specified length.

* Steering wheel stand and M6 screws sold separately.

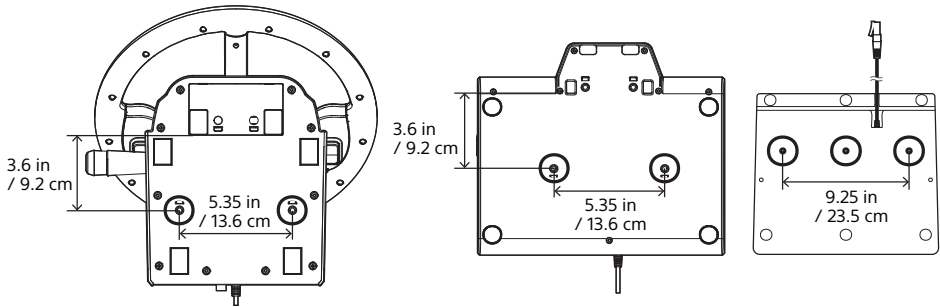

⚠ Length of M6 screws that can be used

* Using screws longer than those listed below may damage internal parts of the Steering Wheel Unit, Control Panel and Foot Pedals.

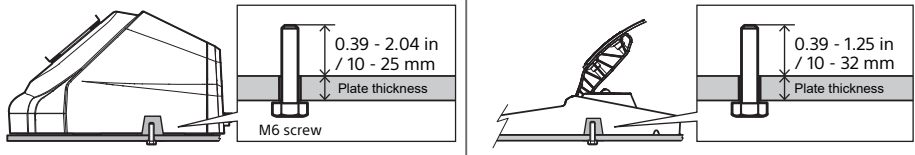

■ Mounting the Steering Wheel Spinner Knob

Please read before installation

⚠ Removing your hand from the Steering Wheel Spinner Knob while in use may unintentionally cause injury. Please handle with care.

⚠ Do not use the Steering Wheel Spinner Knob on an actual vehicle.
⚠ We are not responsible for any malfunction or damage to the vehicle caused by the use of the Steering Wheel Spinner Knob.

1. Unlatch the locking latch and move the Steering Wheel Spinner Knob to the desired position.

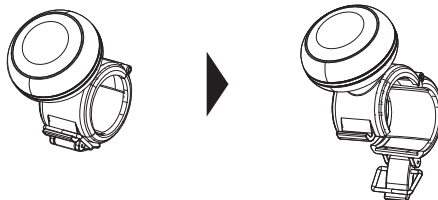

2. Fix the Steering Wheel Spinner Knob in the desired position.

* The shaded areas are the mountable areas.

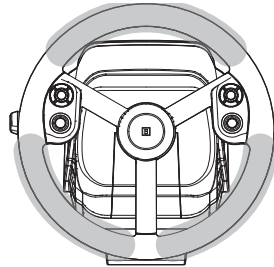
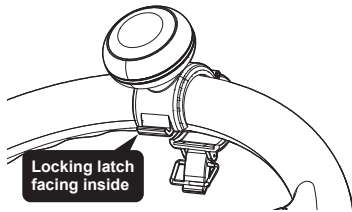

3. Hook the Steering Wheel Spinner Knob into the bracket and push locking latch in until you hear a "click."

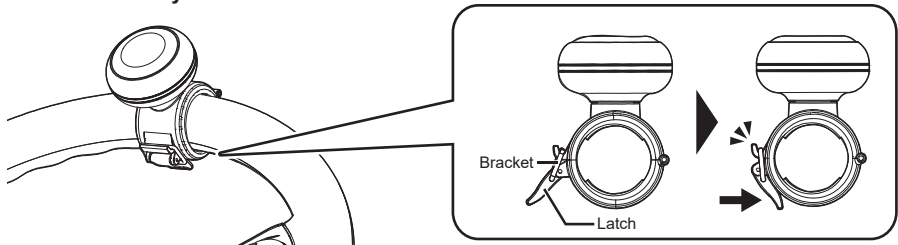

* To remove the Steering Wheel Spinner Knob, reverse steps (1) through (3).

⚠ Do not install as shown in the figure below as it may result in product damage or injury.

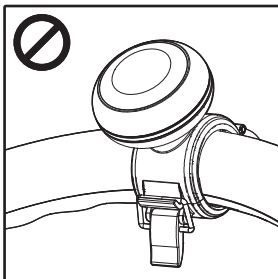

Locking latch is not pushed in all the way.

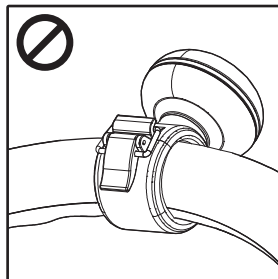

Steering Wheel Spinner Knob is mounted facing outward

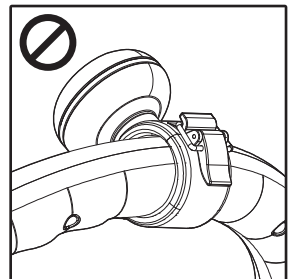

Locking latch is facing outward.

How to Connect

1

Connect in the order of the numbered arrows as shown in the figure below.

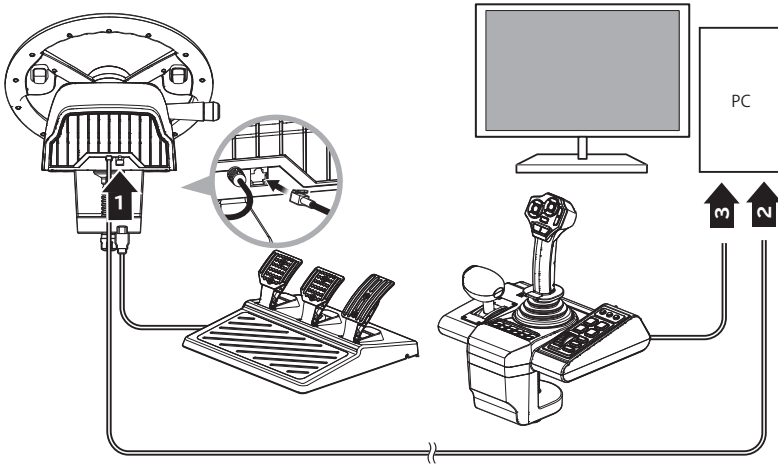

! Please note the following points if this product is not working properly.

- Do not use this product with a USB hub or USB extension cable.
- Do not plug or unplug the USB or modular cable while in use.
- Do not operate the Steering Wheel Unit, Side Panel Unit, or Foot Pedal when connecting the product to a PC, turning on the PC, or waking the PC from sleep mode.

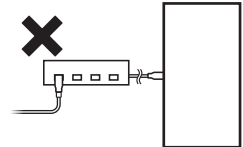

APP [HORI Device Manager]

Customize the racing wheel sensitivity, dead zone and other settings using the companion app

■ Download App

<https://stores.horiusa.com/hpc-043u>

Supported OS	Windows® 11 / 10
System Requirements	USB-A port, Internet Connection

Main Features

Steering Unit

External Dimensions : W 13.8 × D 13.4 × H 10.2 in
/ W 35 × D 34 × H 26 cm

Steering Diameter : 13.4 in / 34 cm

Angle of Rotation : 900°

Weight : 6.1 lbs / 2.75 kg

Connection Type : USB-A port

Cable Length : 9.8 ft / 3 m

Mountable surface thickness : 0.2 ~ 1.8 in / 0.6 ~ 4.5 cm

Control Panel

External Dimensions : W 11.8 × D 10.2 × H 11 in
/ W 30 × D 26 × H 28 cm

Weight : 3.86 lbs / 1.75 kg

Connection Type : USB-A port

Cable Length : 9.8 ft / 3 m

Mountable surface thickness : 0.2 ~ 1.8 in / 0.6 ~ 4.5 cm

Foot Pedals

External Dimensions : W 13.3 × D 11.8 × H 6.3 in
/ W 34 × D 30 × H 16 cm

Weight : 3.1 lbs / 1.4 kg

Connection Type : Modular Cable

Cable Length : 5.9 ft / 1.8 m

Steering Wheel Spinner Knob

External Dimensions : W 2 × D 2 × H 3 in
/ W 5 × D 5 × H 7.5 cm

Weight : 1.4 oz / 40 g

CAUTION:

Any changes or modifications not expressly approved by the party responsible for compliance could void the user's authority to operate the equipment.

THE FCC WANTS YOU TO KNOW

This device complies with part 15 of the FCC Rules. Operation is subject to the following two conditions: (1) This device may not cause harmful interference, and (2) this device must accept any interference received, including interference that may cause undesired operation.

NOTE: This equipment has been tested and found to comply with the limits for a Class B digital device, pursuant to part 15 of the FCC Rules. These limits are designed to provide reasonable protection against harmful interference in a residential installation. This equipment generates, uses and can radiate radio frequency energy and, if not installed and used in accordance with the instructions, may cause harmful interference to radio communications. However, there is no guarantee that interference will not occur in a particular installation.

If this equipment does cause harmful interference to radio or television reception, which can be determined by turning the equipment off and on, the user is encouraged to try to correct the interference by one or more of the following measures:

- Reorient or relocate the receiving antenna.
- Increase the separation between the equipment and receiver.
- Connect the equipment into an outlet on a circuit different from that to which the receiver is connected.
- Consult the dealer or an experienced radio/TV technician for help.

CAN ICES-003(B) / NMB-003(B)

This Class B digital apparatus complies with Canadian ICES-003.
Cet appareil numérique de la classe B est conforme à la norme NMB-003 du Canada.

Simplified Declaration of Conformity

Hereby, HORI declares that this product is in compliance with Directive 2014/53/EU.
The full text of the EU declaration of conformity is available at the following internet address:
<https://hori.co.uk/consumer-information/>

For UK: Hereby, HORI declares that this product is in compliance with the relevant statutory requirements.
The full text of the declaration of conformity is available at the following internet address:
<https://hori.co.uk/consumer-information/>

PRODUCT DISPOSAL INFORMATION

Where you see this symbol on any of our electrical products or packaging, it indicates that the relevant electrical product or battery should not be disposed of as general household waste in Europe. To ensure the correct waste treatment of the product and battery, please dispose of them in accordance with any applicable local laws or requirements for disposal of electrical equipment or batteries. In so doing, you will help to conserve natural resources and improve standards of environmental protection in treatment and disposal of electrical waste.



HORI warrants to the original purchaser that our product purchased new in its original packaging shall be free of any defects in both material and workmanship for a period of one year from the original date of purchase. If the warranty claim cannot be processed through the original retailer, please contact HORI customer support.

For customer support in North America and Latin America, please use our customer support form:
<https://stores.horiusa.com/contact-us/>

For customer support in Europe, please email info@horiuk.com

Warranty information:
<https://stores.horiusa.com/policies/>

-
- Actual product may differ from image.
 - The manufacturer reserves the right to change the product design or specifications without notice.
 - HORI & HORI logo are registered trademarks of HORI.
 - All other trademarks are the property of their respective owners.