



5KMT221
5KMT421



KitchenAid







English	3
Deutsch	00
Français	00
Italiano	00
Nederlands	00
Español	00
Português	00
Ελληνικά	00
Svenska	00
Norsk	00
Suomi	00
Dansk	00
Íslenska	00
Русский	00
Polski	00
Český	00
العربية	00







TOASTER INSTRUCTIONS

TABLE OF CONTENTS

English

TOASTER SAFETY

Important safeguards.....	6
Electrical requirements	7
Electrical equipment waste disposal.....	8

PARTS AND FEATURES

Toaster parts.....	8
Control panel features.....	9
Toaster features	10

OPERATING THE TOASTER

Before first use.....	10
Using the Toaster	10
Using the special toasting functions.....	12

CARE AND CLEANING

TROUBLESHOOTING

WARRANTY AND SERVICE

KitchenAid Toaster warranty	17
Customer service	17



TOASTER SAFETY

Your safety and the safety of others are very important.

We have provided many important safety messages in this manual and on your appliance. Always read and obey all safety messages.



This is the safety alert symbol.

This symbol alerts you to potential hazards that can kill or hurt you and others.

All safety messages will follow the safety alert symbol and either the word “DANGER” or “WARNING.” These words mean:

! DANGER

You can be killed or seriously injured if you don't immediately follow instructions.

! WARNING

You can be killed or seriously injured if you don't follow instructions.

All safety messages will tell you what the potential hazard is, tell you how to reduce the chance of injury, and tell you what can happen if the instructions are not followed.

IMPORTANT SAFEGUARDS

When using electrical appliances, basic safety precautions should always be followed, including the following:

1. Read all instructions.
2. Do not touch hot surfaces. Use handles or knobs.
3. To protect against electrical shock, do not immerse cord, plugs, or toaster in water or other liquid.
4. This appliance can be used by children aged from 8 years and above and persons with reduced physical, sensory or mental capabilities or lack of experience and knowledge if they have been given supervision or instruction concerning use of the appliance in a safe way and understand hazards involved. Children shall not play with the appliance. Cleaning and user maintenance shall not be made by children without supervision.
5. Unplug toaster from outlet when not in use and before cleaning. Allow to cool before putting on or taking off parts.
6. Do not operate any appliance with a damaged cord or plug or after the appliance malfunctions or has been damaged in any manner. Return appliance to the nearest Authorized Service Facility for examination, repair or adjustment.
7. The use of accessory attachments not recommended by the appliance manufacturer may cause injuries.





TOASTER SAFETY

8. Do not use outdoors.
9. Do not let cord hang over edge of table or counter, or touch hot surfaces.
10. Do not place on or near a hot gas or electric burner, or in a heated oven.
11. To disconnect, turn any control to “OFF,” then remove plug from outlet.
12. Do not use appliance for other than intended use.
13. Oversize foods, metal foil packages, or utensils must not be inserted in toaster as they may involve a risk of fire or electric shock.
14. A fire may occur if toaster is covered with or touching flammable material, including curtains, draperies, walls and the like, when in operation.
15. Do not attempt to dislodge food when toaster is plugged in.
16. Appliance is not intended to be operated by means of an external timer or remote-control system.
17. **This product is designed for household use only.**

SAVE THESE INSTRUCTIONS

Electrical requirements

Voltage: 220-240 Volts

Frequency: 50/60 Hertz

Wattage: 1100 Watts for the
2-slice model 5KMT221

1800 Watts for the
4-slice model 5KMT421

NOTE: If the power cord is damaged, it must be replaced by the manufacturer or its service agent in order to avoid a hazard. Do not use an extension cord. If the power supply cord is too short, have a qualified electrician or serviceman install an outlet near the appliance.

⚠ WARNING



Electrical Shock Hazard

Plug into a grounded outlet.

Do not remove ground prong.

Do not use an adapter.

Do not use an extension cord.

Failure to follow these instructions can result in death, fire, or electrical shock.



TOASTER SAFETY

Electrical equipment waste disposal

Disposal of packing material

The packing material is 100% recyclable and is marked with the recycle symbol . The various parts of the packing must therefore be disposed of responsibly and in full compliance with local authority regulations governing waste disposal.

Scrapping the product

- This appliance is marked in compliance with European Directive 2002/96/EC, Waste Electrical and Electronic Equipment (WEEE).
- By ensuring this product is disposed of correctly, you will help prevent potential negative consequences for the environment and human health, which could otherwise be caused by inappropriate waste handling of this product.

- The symbol  on the product or on the accompanying documentation indicates that it should not be treated as domestic waste but must be taken to an appropriate collection centre for the recycling of electrical and electronic equipment.

For more detailed information about treatment, recovery and recycling of this product, please contact your local city office, your household waste disposal service or the shop where you purchased the product.

PARTS AND FEATURES

Toaster parts

2-slice model

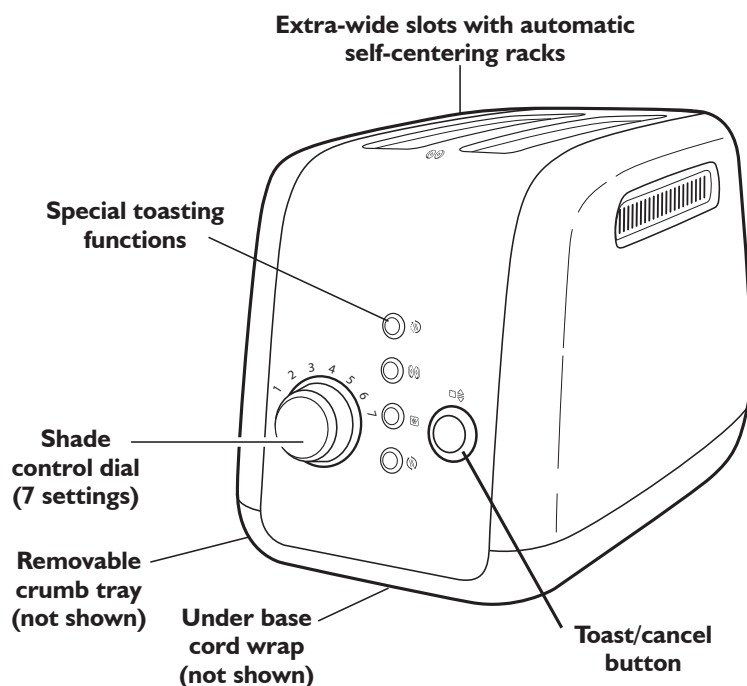



PARTS AND FEATURES

Toaster parts

4-slice model

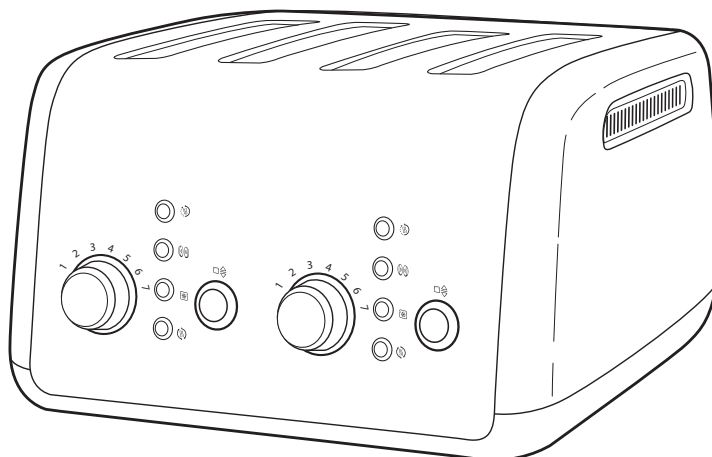

English

Same great parts and features as 2-slice model, with **two independent control panels** that allow you to select different settings for each pair of slots.

Optional accessories

A Bun Warmer (model 5KTBW21) and a Sandwich Rack (model 5KTSR1) can be purchased as optional accessories to be used with the 2-slice and 4-slice toasters.

Control panel features

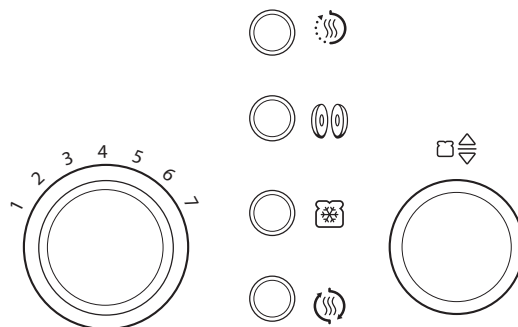

Shade control dial

Features a rotating knob for precision control (7 settings). Turn knob to the right for darker or to the left for lighter toasting.

Keep warm function ()

Select to keep warm slices that have just been toasted (up to 3 minutes). The End-of-Cycle signal will beep and the toaster will shut off and raise the slices.

Bagel function ()

Designed to toast bagels, crumpets, muffins, buns or any other round breads that you wish to cut in half and toast only on one side. The heating elements will adjust to

nicely toast the inside of a cut bagel (or other round bread) while gently warming the outer surface.

Frozen function ()

Defrosts and toasts frozen bread.

Reheat function ()

Quickly reheats slices in less than a minute.

Toast/Cancel button ()

Lowers the slices and starts the toasting cycle / cancels the cycle and lifts the slices. A ring of light around the button illuminates when the heaters are actively toasting.





PARTS AND FEATURES

Toaster features

Extra-wide slots

Handles thick bread slices, buns or bagels easily.

Self-centering bread racks

Centers thick or thin breads perfectly for even toasting.

Removable crumb tray(s)

Durable steel tray (two side-by-side trays on 4-slot model) can be washed in the top rack of a dishwasher.

Under base cord wrap

Keeps extra cord out of sight and out of the way.

Stylish exterior

Stainless steel and painted steel surfaces are constructed for durability and style.

Steel interior

Durable and deep toasting cavity helps to ensure even browning.

OPERATING THE TOASTER

Before first use

Before using your Toaster, check the Extra-Wide Slots and remove any packing or printed material that might have fallen inside during shipping or handling. Do not probe inside the Toaster with a metal object.

You may see light smoke the first time you use the Toaster. This is normal. The smoke is harmless and will soon disappear.

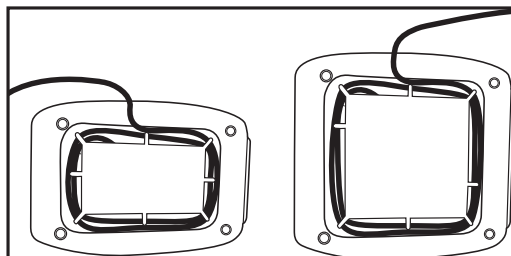

Shorten cord, if necessary, by wrapping cord under the base. The Toaster's feet are tall enough to allow the cord to exit from under any side of the Toaster.

Using the Toaster

! WARNING

**Electrical Shock Hazard**

Plug into a grounded outlet.

Do not remove ground prong.

Do not use an adapter.

Do not use an extension cord.

Failure to follow these instructions can result in death, fire, or electrical shock.

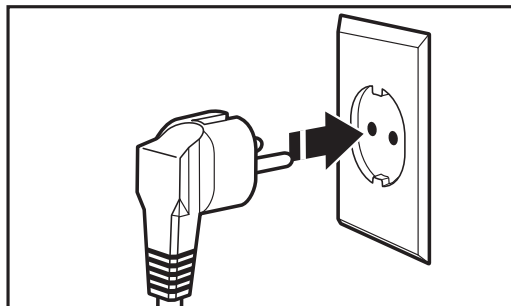

Plug the Toaster cord into a grounded outlet.





OPERATING THE TOASTER

Using the Toaster

English

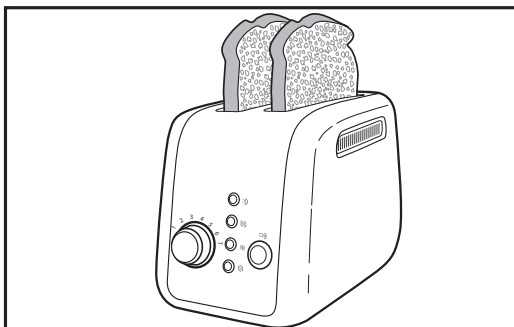

- 2** Insert bread or other food to be toasted in slot.

NOTE: For even toasting on 2-slice models, toast only one bread type and thickness at a time. For 4-slice models, with Dual Independent Controls, if toasting of two different breads is desired, be sure to toast only one bread type in each pair of slots.

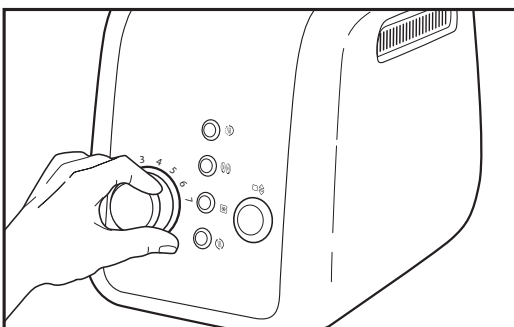

- 3** Turn the Shade Control dial to select the degree of darkness you want. Turn it to the right for darker toasting or to the left for lighter.

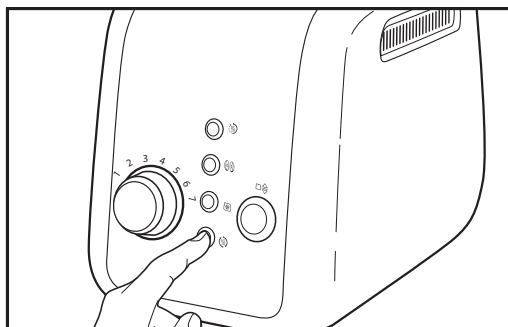

- 4** (Optional) Press desired special toasting function button. See the "Using the special toasting functions" section for more information.

NOTE: Different types of bread and their moisture levels may require different shade settings. For example, dry bread will brown more rapidly than moist bread and will require a lighter setting.

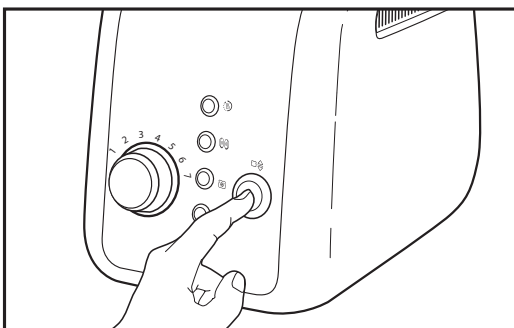

- 5** Press the TOAST/CANCEL (☐☞) button to begin toasting. The centering racks will adjust automatically to hold food upright. When toasting is complete, the End-of-Cycle signal will beep, the Toaster will shut off and raise the toast.

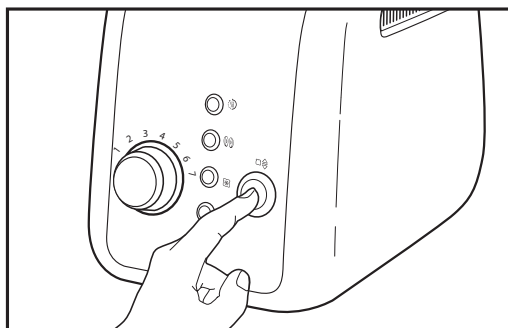

- 6** To cancel toasting at any time, press TOAST/CANCEL (☐☞) button again. The Toaster will shut off and raise the toast.





OPERATING THE TOASTER

Using the special toasting functions

Either before, or just after pressing TOAST/CANCEL button to begin toasting, you can select the special toasting functions by pressing the appropriate button. After a toasting cycle is complete, all functions will be cleared.

Keep Warm function (☼)

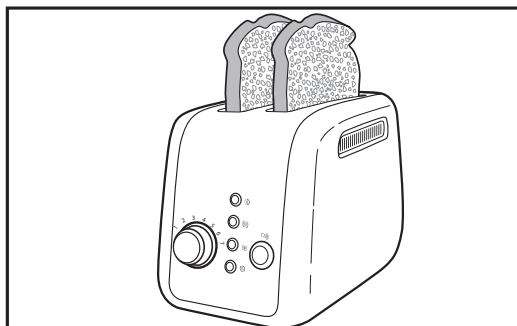

1 Make sure the just toasted food is still in the slot, or place it back in the Toaster.

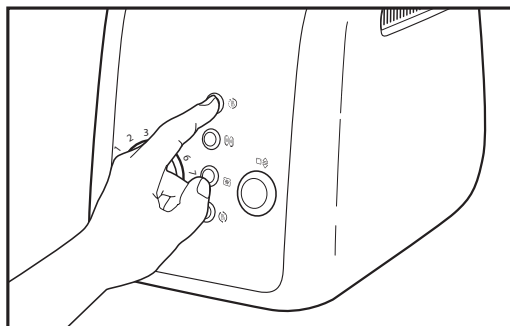

2 Press the KEEP WARM (☼) button.

NOTE: No Shade adjustment is necessary – the Keep Warm function overrides whatever Shade level you have set.

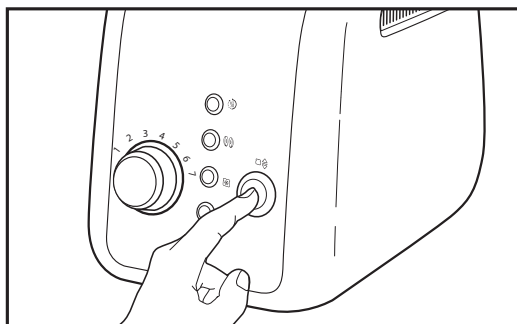

3 Press the TOAST/CANCEL (☼) button to begin the warming cycle.

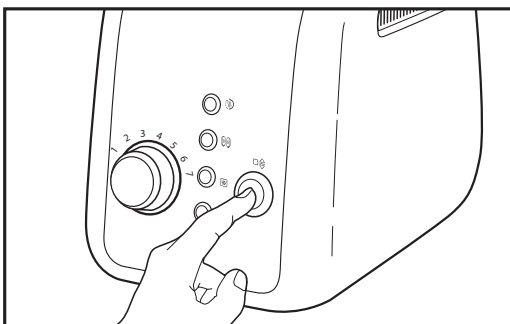

4 To cancel warming at any time, press TOAST/CANCEL (☼) button again. The Toaster will shut off after 3 minutes and raise the toast.

Bagel function (00)

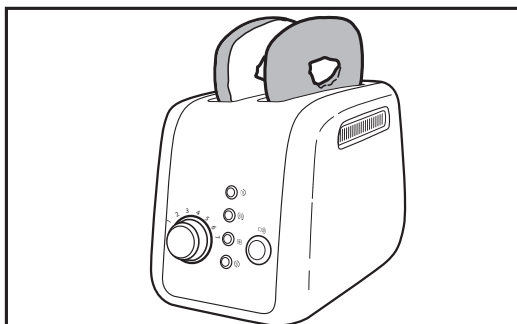

1 Insert the halves of bagel (or of other round breads) with the flat side facing in, as shown.

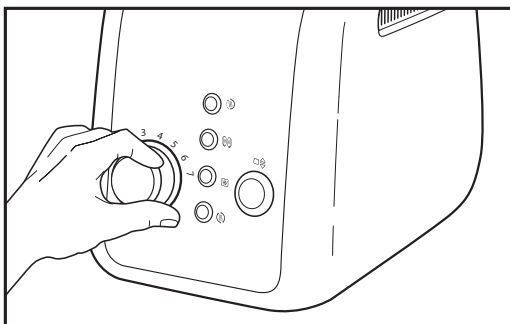

2 Set the Shade Control to the desired level.





OPERATING THE TOASTER

Using the special toasting functions

English

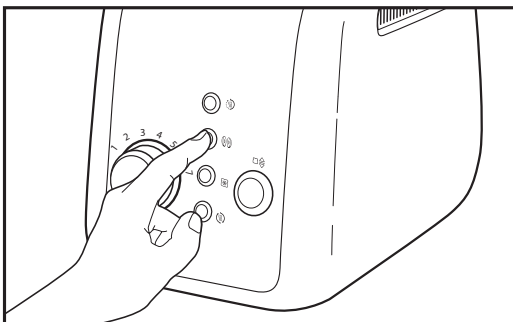

3 Press the BAGEL (☉) button.

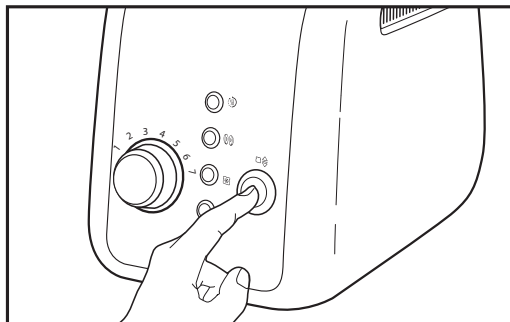

4 Press the TOAST/CANCEL (☐) button to begin toasting.

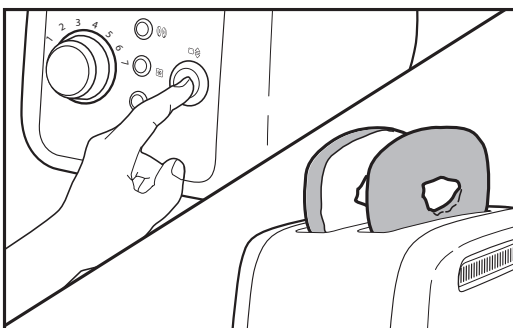

5 To cancel toasting at any time, press the TOAST/CANCEL (☐) button again. The Toaster will shut off and raise the bagel.

Frozen function (❄)

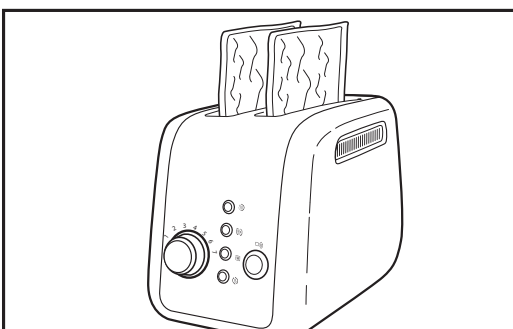

1 Insert the frozen item into bread slot. Use the Frozen function for frozen foods only.

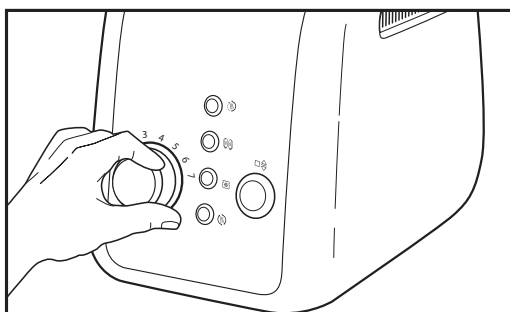

2 Set the Shade Control to the desired level.





OPERATING THE TOASTER

Using the special toasting functions

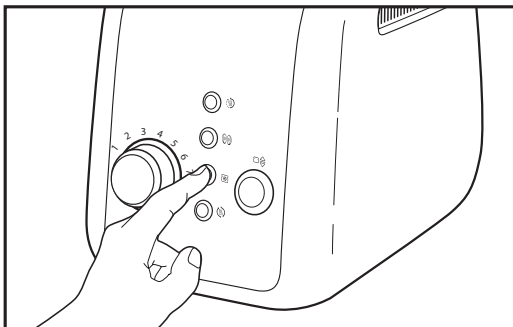

3 Press the FROZEN (❄️) button.

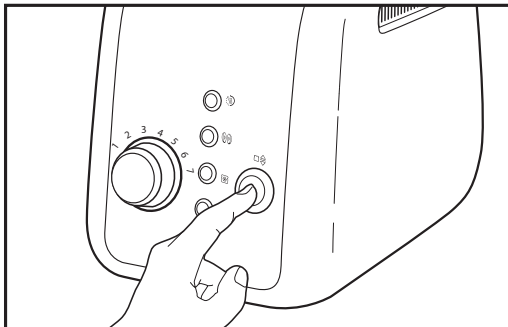

4 Press the TOAST/CANCEL (☐/🛑) button to begin toasting.

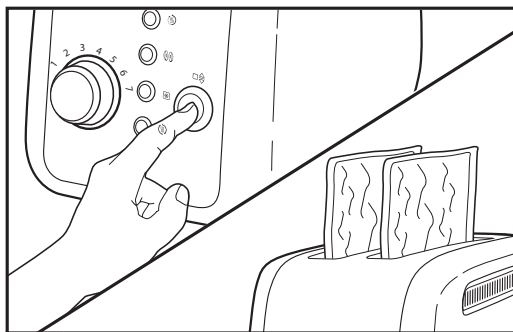

5 To cancel toasting at any time, press the TOAST/CANCEL (☐/🛑) button again. The Toaster will shut off and raise the toasted item.

Reheat function (🔥)

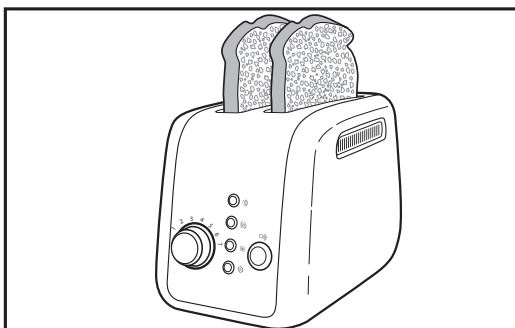

1 Insert the food into Toaster slot. Do not place food with butter or any other topping in the Toaster. Use the Reheat function for dry foods only.

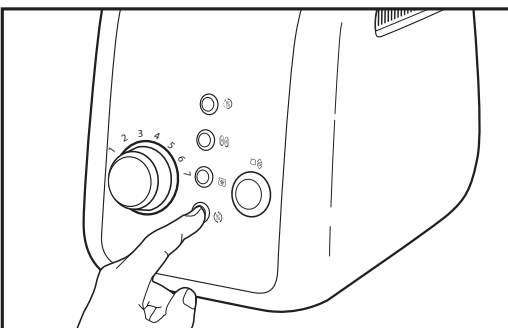

2 Press the REHEAT button (🔥).





OPERATING THE TOASTER

Using the special toasting functions

NOTE: No Shade adjustment is necessary – the Reheat function overrides whatever Shade level you have set.

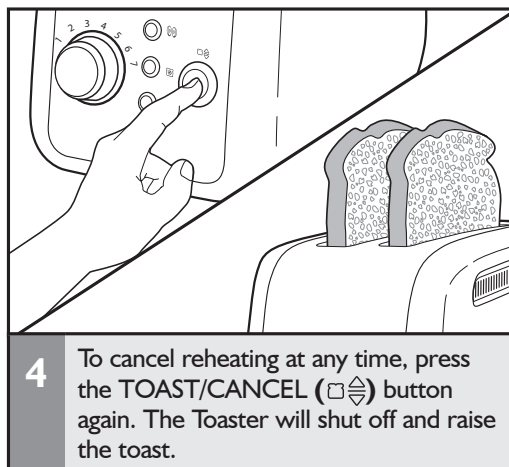
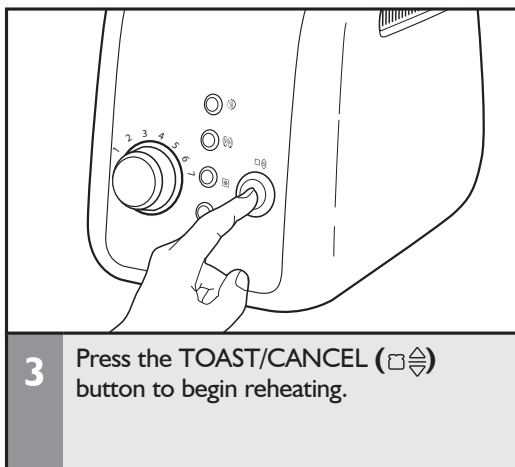

English

CARE AND CLEANING

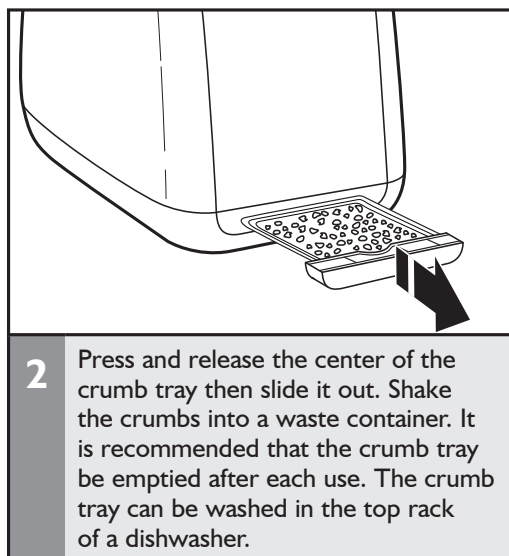
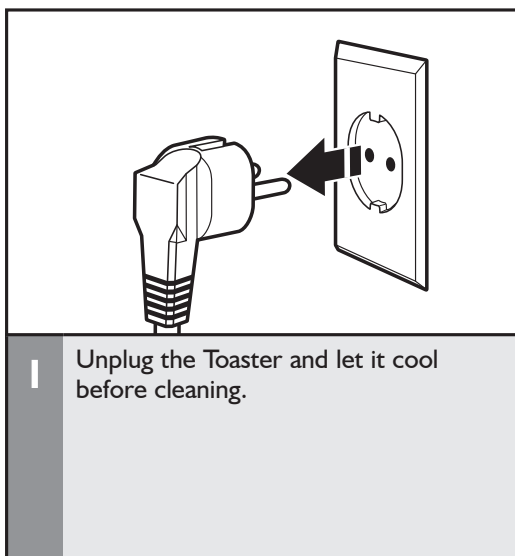

IMPORTANT: The tray will be hot immediately following a toasting cycle.



CARE AND CLEANING

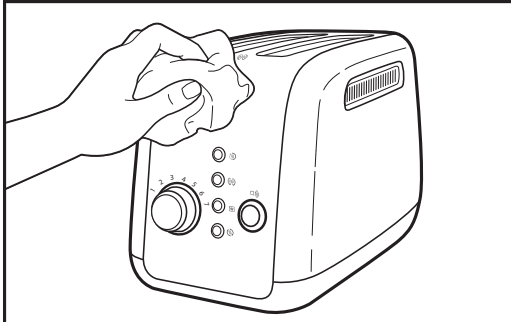

- 3** Wipe Toaster with a soft, damp cotton cloth. Do not use paper towels, abrasive cleansers or liquid cleaning products. Do not immerse Toaster in water.

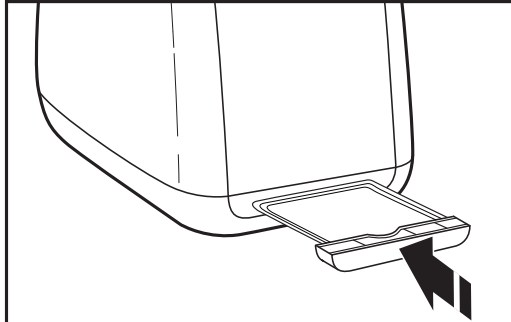

- 4** Return crumb tray to Toaster. Press it in firmly until it clicks into position. Do not use the Toaster without the crumb tray in proper position.

NOTE: If grease or oil splatters on the Toaster, wipe splatters away immediately using a clean, damp cotton cloth.

NOTE: KitchenAid does not recommend the use of a toaster cover.

TROUBLESHOOTING

- If your Toaster should fail to operate, check the following:

1. Check that the Toaster is plugged into a proper electrical outlet. If it is, unplug the Toaster.
2. Plug in Toaster.
3. If the Toaster still does not work, check the household fuse or circuit breaker.

- If the problem cannot be corrected: See the "Warranty and service" sections.

⚠ WARNING



Electrical Shock Hazard

Plug into a grounded outlet.

Do not remove ground prong.

Do not use an adapter.

Do not use an extension cord.

Failure to follow these instructions can result in death, fire, or electrical shock.



WARRANTY AND SERVICE

KitchenAid Toaster warranty

Length of Warranty:	KitchenAid Will Pay For:	KitchenAid Will Not Pay For:
Europe, Middle East and Africa: Two years full warranty from date of purchase.	The replacement parts and repair labor costs to correct defects in materials or workmanship. Service must be provided by an Authorized KitchenAid Service Center.	A. Repairs when Toaster is used for operations other than normal household food preparation. B. Damage resulting from accident, alterations, misuse, abuse, or installation/operation not in accordance with local electrical codes.

English

KITCHENAID DOES NOT ASSUME ANY RESPONSIBILITY FOR INDIRECT DAMAGES.

Customer service

In U.K. and Ireland:

For any questions, or to find the nearest KitchenAid Authorized Service Center, please find our contact details below.

NOTE: All service should be handled locally by an Authorized KitchenAid Service Center.

Contact number for U.K. and Northern Ireland:

Tollfree number 0800 988 1266 (calls from mobile phones are charged standard network rate)

Contact number for Ireland:

Tollfree number +44 (0) 20 8616 5148

E-mail contact for U.K. and Ireland:

Go to www.kitchenaid.co.uk, and click on the link "Contact Us" at the bottom of the page.

Address for U.K. and Ireland:

KitchenAid Europa, Inc.
PO BOX 19
B-2018 ANTWERP 11
BELGIUM

In other countries:

For all product related questions and after sales matters, please contact your dealer to obtain the name of the nearest Authorized KitchenAid Service/Customer Center.

www.KitchenAid.eu

© 2013. All rights reserved.
Specifications subject to change without notice.





KitchenAid

© 2013. All rights reserved.
Specifications subject to change without notice.

W10625929A

09/13