

UNITED®

Instructions Manual



Model:SC-5205

Read these instructions carefully and keep them for future reference.

Index	Page
Important safeguards.....	3
Important safety instructions.....	4
Description of the appliance.....	5
Instructions for use.....	6
Suggested attachment uses.....	7
Using.....	8
Filling the boiler with water.....	8
Filling with detergent	8
Using.....	9
Starting the appliance.....	10
Helpful tips.....	10
Refilling your steamer.....	11
Clean detergent.....	11
Maintenance.....	11
Technical data.....	12



Please note the following safety notes to avoid malfunctions, damage or physical injury:

- This appliance is not intended for use by persons (including children) with reduced physical sensory or mental capabilities, or lack of experience and knowledge, unless they have been given supervision or instruction concerning use of the appliance by a person responsible for their safety.
- Children should be supervised to ensure that they do not play with the appliance.
- Make sure the voltage corresponds to the type label on the appliance.
- Never leave the appliance unsupervised when in use. Keep out of reach of children or persons in need of supervision. When not in use pull the power plug.
- Never direct the hand steam cleaner towards people, animals or plants. Do not point the hand steam cleaner towards equipment containing electronic components or against sensitive surfaces.
- **Warning: Danger of Scalding!** Please use caution when using the steam cleaner. The steam emitted from the openings is very hot.
- Do not switch on the hand steam cleaner before filling the water tank. Never open the safety seal during operation. Due to the existing pressure there is risk of injury!
- Only fill the hand steam cleaner tank with water resp. distilled water. Do not fill any other liquids in the tank. There is risk of explosion!
- Use the hand steam cleaner only with the included accessory. Attention! The accessory might become hot during use. First allow the accessory to cool down before removing.
- Do not insert any objects into the hand steamer openings.
- Do not immerse the appliance in water or any other liquid or use the appliance with wet hands.
- Please unplug the hand steam cleaner from the power supply before cleaning, filling water or when not in use.
- Do not overfill the water tank. Only use the included measuring cup for filling.
- Let the hand steam cleaner fully cool down before storing it. Only carry the appliance by the handle or by the shoulder strap.



- Do not expose the appliance to rain and do not direct the steam towards the hand steam cleaner.
- Store the hand steam cleaner in a dry place.
- Insert the power plug to a grounded wall socket only. Do not pull the power cord to unplug, but grasp the plug to remove from the wall socket.
- Do not close cord in doors or pull cord around sharp edges or corners. Do not pinch or crimp the power cord in any way. Keep the power cord away from hot surfaces.
- Make sure the cord does not become a tripping hazard.
- Only use the appliance for domestic purposes and in the way indicated in this manual. The appliance is not designed for continuous, professional use.
- Should the appliance become damaged do not use it and have it repaired by a professional or contact our customer support department.
- Do not use the hand steam cleaner if the appliance itself or the power cord is damaged.
- Do not disassemble the appliance or try repairing it yourself.

IMPORTANT SAFETY INSTRUCTIONS

- 1.To avoid circuit overload, do not operate appliance on the same socket (circuit) with other devices.
- 2.Do not leave steamer unattended when plugged in.

CAUTION: this product is NOT designed to be disassembled. Any attempt to take apart your steamer after assembly will cause damage. Do not leave the steamer unattended.



Children should be supervised to ensure that they do not play with the appliance.

DESCRIPTION OF THE APPLIANCE

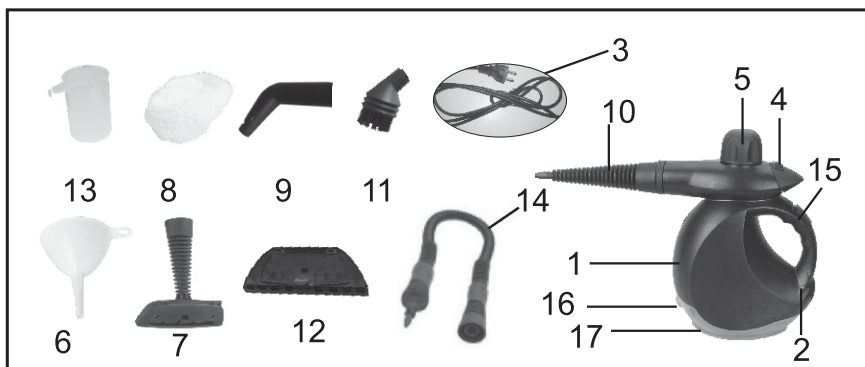

- 1.Main body
- 2.Indicator light.
- 3.Power Cord.
- 4.Steam Lever.
- 5.Boiler cap.
- 6.Funnel.
- 7.Upholstery Nozzle-the flat surface covers wide areas.
- 8.Cloth Cover-the fabric cover is best for stain removal from upholstery and carpets.
- 9.Bent spray Nozzle - for hard to reach areas.
- 10.Long spray nozzle - standard attachment with fine point spray end.
- 11.Spray cup with round Brush - For Smaller areas and appliances. Ideal for detail work and scrubbing.
- 12.Spray Nozzle for Window - attaches to the Upholstery Nozzle for cleaning glass.
- 13.Refill cup - for filling the appliance with water.
- 14.Extended connecting spray nozzle
- 15.Detergent release button
- 16.Detergent case

INSTRUCTIONS FOR USE

The Steam Cleaner can clean and sanitize all types of surfaces designed to withstand high temperatures such as marble, ceramic, stone sealed wood, sealed grout, cook tops, window, mirrors, etc.

1. Remember that is a 2 in 1 tool
2. The STEAM ONLY setting has a high degree of cleaning and degreasing power. Pure steam power can assist in the removal of dirt, grease and grime on a wide variety of surfaces.
3. Surfaces that can be safely cleaned in the STEAM ONLY setting includes virtually all hard surfaces that can withstand high temperatures.
4. The power of STEAM ONLY can also remove wrinkles from clothing, draperies and other cloth items that are not harmed by moisture.
5. STEAM ONLY is also effective in cleaning hard to reach or detailed/intricate surfaces like exhaust filters over stoves, outdoor furniture, outdoor grills, golf clubs and many many other items.
6. The detergent empowers the pure steam by adding sanitizing and disinfecting power to your cleaning tasks.
7. Do not use on unsealed wood surfaces, unsealed grout, cold glass or soft plastic surfaces.

SUGGESTED USE OF THE ACCESSORIES

BAYONET
 For general purpose
 and spot cleaning



GENERAL SPRAY NOZZLE
 Perfect for scrubbing countertops,
 stovetops, vents and tilework



BENT SPRAY NOZZLE
 For door runners, grooves, appliances
 and reaching into small areas.

UPHOLSTERY NOZZLE
 Perfect for clothing, fabrics, stain removal,
 drapes, cabinets and larger areas.



SPRAY NOZZLE FOR WINDOW
 Works on windows, glass, countertops,
 doors, vertical and slick surfaces.

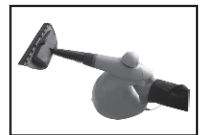
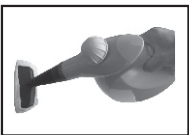
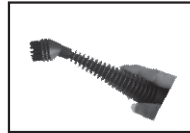

USING

STEP 1

FILLING THE BOILER WITH WATER

WARNING:carefully read all instructions before unscrewing the safety cap.

WARNING:always unplug the appliance before filling the boiler.

WARNING:do not add detergents, perfumes, oils or other chemical substances to the water, used to fill upper/top section of your steamer
Use tap water (or distilled water if tap water is too hard).

FOLLOW THESE INSTRUCTIONS TO AVOID WATER FROM OVERFLOWING

- A. Press the BOILER CUP and turn counter clockwise
- B. Fill the REFILL CUP with water (10 oz. / 300 ml) and fill the upper tank
DO NOT LET WATER OVERFLOW
- C. Replace BOILER CUP by pressing down and turning clockwise until full resistance is felt. The upper position of the cap will rise a spin freely.

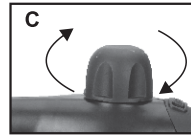
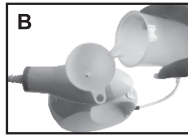
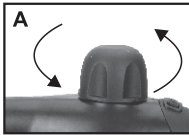

STEP 2

FILLING WITH DETERGENT

- A. The separate detergent tank can be filled by pressing the release button and detach the tank as shown below.
- B. Unscrew the cap and fill with detergent. You can fill the reservoir to the top.
- C. Replace the cap and re-attach the tank to the bottom of the steam cleaner as shown in fig.C.

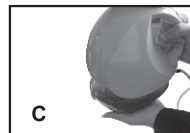

STEP 3

USING

- A. After filling with water choose the accessories you will need
- B. Based on the job, attach the BAYONET TIP to the EXTENSION HOSE or DIRECTLY TO YOUR STEAMER.
- C. Attach the BAYONET directly to your steamer as shown below.
- D. All attachments can be attached to either the BAYONET TIP or the EXTENSION HOSE.
- E. The BRUSHERS and ANGLE NOZZLE can be attached to the Bayonet nozzle by pressing and turning.

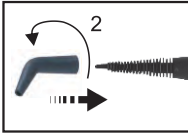
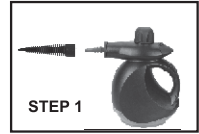

Metal and Nylon Round Brush(*)
Round Brush recommended for sealed grout, cook tops and bench tops.



WARNING: Metal brush will scratch surfaces. Only use to remove tough debris on surfaces able to withstand abrasive contact.



Angled Nozzle(*)
Curved Nozzle recommended for hard to reach area such as window sills and toilet.

- F. TO use the Window Cleaning attachment clip it into the Fabric Accessory by hooking the two hinges onto the tabs and lifting the window cleaner around to the top of the fabric tool and clipping the latch onto the fabric cleaner to secure. To remove the window cleaner, simply lift the latch to unclip and separate.



Window Squeegee(*)

WARNING: Using window cleaner on cold glass may result the glass to break. Proceed with caution when carrying out this operation.

- G. To use the Fabric Accessory, stretch the Cloth Covering to fit over the Fabric Accessory. It is recommended that the Fabric Accessory be attached to the flexible hose for maximum accessibility for clothing, upholstery and window furnishings.



Cloth Cover(*)

STARTING THE APPLIANCE

- A. Insert the plug into a suitable wall socket. A green light will glow showing that the appliance is ON

NOTE:The green light is designed to show you that the steamer is on and working. It will stop glowing when the appliance is unplugged.

- B. The device should be ready to steam in 3-5 minutes.
Fill with warm water for faster cycle time
- C. After 3-5 minutes you are ready to go.

WARNING:NEVER LEAVE YOUR STEAM CLEANER UNATTENDED

- D. To engage the STEAM ONLY cleaning power, simply press the STEAM LEVER downward and hold in position.
- E. To engage the STEAM/Detergent cleaning and disinfecting power, slide the button on the handle to the down position before pressing the STEAM LEVER.

HINT:Please be aware that when the Detergent is “ON” position the steam output may appear more “humid”. This is normal because the hot steam gets mixed with the Clean Detergent product and as a result the steam will appear “thicker” .

HELPFUL TIPS

- A. Keep in mind you can choose to either clean with chemical free pure steam or add the power of detergent to disinfect and sanitize.
- B. For very persistent stains or heavy soiling, HOLD THE END OF THE BAYONET TIP ABOUT 1/4” ABOVE THE AREA AND HOLD FOR SEVERAL SECONDS.
- C. If your water is hard, always use distilled water to extend the LIFE and POWER of your appliance.



REFILLING YOUR STEAMER

WATER

- A. Unplug the power cord from electrical outlet.
- B. Press and hold steam lever until all pressure has been released.
- C. Before opening Water Tank Cap it is important to wait approximately 3 minutes for the appliance to cool down. Slowly turn the cap, only a half turn and wait for the hissing sound (if any) to completely stop. The hissing sound may be present due to residual pressure not released while holding the steam lever.
- D. Carefully press the cap and unscrew it and follow process outlined in **STEP1.**

DETERGENT

- A. The separate detergent tank can be refilled by pressing the release button and detach the tank. See **STEP2.**

MAINTENANCE

NOTE: Please ensure the steam cleaner has been unplugged from the power source and cooled down before any cleaning and maintenance is carried out.

- Always empty any excess water from water tank after each use. This operation will prolong the life of your appliance.
- Always ensure the unit has cooled down before putting it away in a dry, cool place.
- To ensure the highest level of operation over a long period of time, it is recommended that the water tank be rinsed out with water at least once a month to clean any water calcification accumulated. Do not use vinegar or other substances to remove lime scale deposits.
- To clean fill with one measure of water, replace cap and shake unit to loosen any lime scale deposits. Remove cap and empty water from tank.
WARNING: Do not immerse the steam cleaner in water.

NOTE: This appliance is not intended for use by persons (including children) with reduced physical, sensory or mental capabilities, or lack of experience and knowledge, unless they have been given supervision or instruction concerning use of the appliance by a person responsible for their safety.

Children should be supervised to ensure that they do not play with the appliance.

TECHNICAL SPECIFICATIONS

Voltage: 220-240V~ 50Hz

Power: 1200 Watt

Maximum capacity: 520ml+0/-20ml

Suggest use: 350ml

NOTICE ABOUT RECYCLING



Your product is designed and manufactured with high quality materials and components which can be recycled and reused. This symbol means that electrical and electronic equipment, at their end-of-life, should be disposed of separately from your household waste. Please dispose of this equipment at your local community waste collection/ recycling centre.

In the European Union there are separate collection systems for used electrical and electronic products.

Please help us to conserve the environment we live in!

DECLARATION OF CONFORMITY

Herewith, Amiridis-Savvidis S.A. states that this product, complies with the requirements of below directives:

EMC-Directive: 14 / 30 / EU

Low Voltage Directive: 14/ 35 / EU

ErP Directive 09 / 125 / EC

CE Marking: 93 / 68 / EEC

RoHS Directive: 11 / 65 / EU

The detailed declaration of conformity can be found at www.united-electronics.gr



Exclusive importer in Greece:

Amiridis – Savvidis S.A.

87A, 17th Noemvriou str, P.C. 55534

Thessaloniki – Greece

T: +302310944944 | F: +302310944940

www.amiridis-savvidis.gr